

Part # 22-2175

GENERAL OPERATING INSTRUCTIONS: *A/C Flush-It™ Hoon Yocker™*

**I KNOW,
I KNOW**

***It's Your Investment -
- But, It's Our NAME! So, Read
Carefully Before Using Equipment***

DISCLAIMER

We believe the information contained herein to be reliable. However, general technical information is given by us without charge and the user shall employ such information at his own discretion and risk. We assume no responsibility for results or damages incurred from the use of such information in whole or in part. ***Always refer to specific instructions and technical information supplied by vehicle manufacturer.***

All warranties expressed or implied, including warranties on merchantability and fitness of purpose, are null and void if the equipment is altered, damaged or misused in any way, or if equipment is not repaired by authorized repair station using authorized parts.



HOW IT WORKS

We use an Ester based material containing various additives for servicing one component or an entire system. These special additives clean, suspend particulates and add corrosive resistance. After the solution has been circulated through the patented ***A/C Flush-It™ Hoon Yocker™***, the motor is turned off and the air pressure valve turned on to purge. Purge the system until return hose is clear of flush. ***It's That Simple!***

CLOSED LOOP OBJECTIVE

The ***A/C Flush-It™ Hoon Yocker 's™*** objective is to properly clean the A/C system by removing dirt and debris which could cause continuous, and often severe, A/C systems failures.

Flush fluid is continuously pumped through the vehicle A/C System and a flush filter to insure the removal of these contaminants.

This process insures that dirt and debris are carried out of the vehicle A/C system into the filtration system of the ***A/C Flush-It™ Hoon Yocker™***, and is filtered so that clean flush returns into the A/C system to continue removing dirt and debris. This process may continue as long as needed to insure a clean system.



INSTRUCTIONS

FLUSH

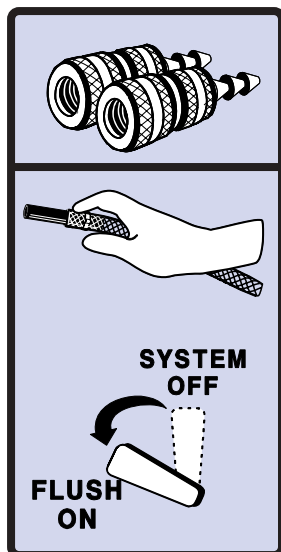

Attach Cobra™ Couplers to Vehicle to Flush

Attach Dry Shop Air to Flush Fittings with Valve in **OFF** Position. Turn Lever to **ON** Position and Start **FLUSHING** (20 to 30 Minutes). When Flushing is Complete, Turn Lever to **OFF** Position

PURGE

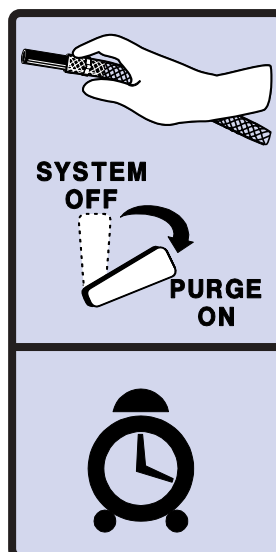

DISCONNECT Air Hose from **FLUSH** Side and Connect to **PURGE** Side. Turn Purge Lever to **ON** Position.

PURGE Until Return Hose Shows **ALL FLUSH** has Been Removed. Turn Purge Lever to **OFF** Position

REPEAT ABOVE ON OTHER SIDE OF SYSTEM

QUICK TIPS

- ✓ Maintain 70-125 PSI (Minimum) to Flush Machine
- ✓ Only Flush 1/2 System at a Time
- ✓ Always Maintain 2 Gallon Level
- ✓ Check Flush Level After Each Flush
- ✓ Never Over Tighten Filter
- ✓ Use Only Ester Flush
- ✓ Change Flush Filter Often (10-15 Flushes)
- ✓ For Extremely Clogged Systems, Allow Flush to Stand in Component for 30 Minutes Before Flushing. (Repeat as Needed)

MAINTENANCE TIPS

- ✓ To Change Flush, Place Outlet Coupler in a Container and Start Flush Cycle Until Empty. Then Change Flush Filter, Fill with 2 Gallons of Cobra™ Ester Flush. ***It's That Simple!***
- ✓ Always Dispose of Flush in an Environmentally Safe Manner, and In Accordance with State and Local Laws
- ✓ When Not in Use, Store in Dry, Safe Place
- ✓ At the Beginning of Season, and as Needed During the A/C Season - Change Air Filter
- ✓ Clean Exterior of Machine with Mild Soap and Water



DESCRIPTION

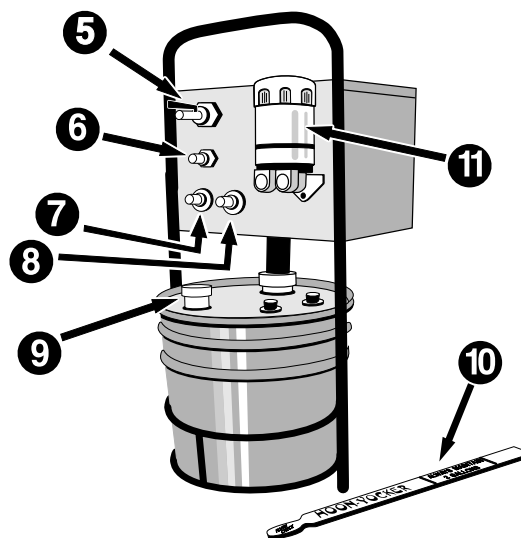
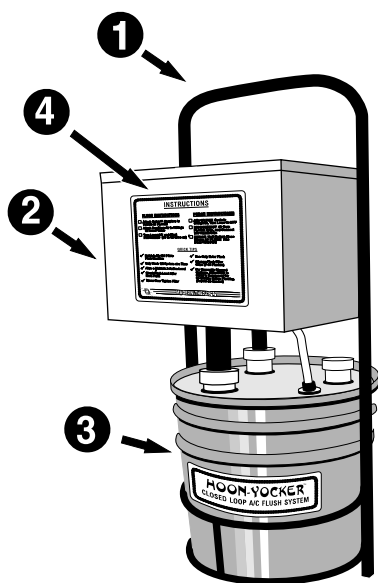

- 1 Handle & Holder
- 2 Cover
- 3 Reservoir Tank
- 4* Instruction Panel (Permanently Affixed to Machine)

- 5 Air Inlet (Flush Cycle) with Level Valve
- 6 Air Inlet (Purge Cycle) without Level Valve
- 7 Flush Outlet
- 8 Flush Inlet
- 9 Filler Spout
- 10 Fluid Level Measurer
- 11 Flush Filter & Housing

**For Your Convenience, Instructions are Permanently Affixed to Machine*

DO:

- Remove Oil From System Before Flushing
- Set Air Pressure Between 70-125 PSI
- DO - Check Flush Level Before and After Each Use
- DO - 1/2 the System at a Time
- Maintain 1 Gallon Minimum Reservoir, 2 Gallons for Optimal Performance
- DO - Change Filter Every 10-15 Flushes or after Cleaning Badly Contaminated Systems
- DO - Check Your Air Compressor for Water
- Wear Gloves & Eye Protection
- DO - Call Us If You Have A Question, An Opinion, or Comments - 845-562-1442
- DO - Return Warranty Card



DO NOT:



- DO NOT - Flush the Whole System at One Time
- DO NOT - Use Any Flush Solution Not Recommended for Your Flush-It™ Hoon Yocker™
- DO NOT - Run Machine Empty
- DO NOT - Exceed 125 PSI For Any Reason
- DO NOT - Attempt to Service Machine Internally. (Call for Service - 845-562-1442)
- DO NOT - Flush System Without Removing as Much Oil as Possible
- DO NOT - Flush Through Compressor
- DO NOT - Flush Through Accumulator-Drier or Receiver-Drier



TROUBLE SHOOTING THE MACHINE

- ☑ Remove Cobra™ Coupler from Vehicle (if applicable)
- ☑ Check Air Supply (70 to 125 PSI)
- ☑ Check Flush (2 Gallons)
- ☑ Check Filters
 - ◆ If the Most Recent System Required Special Attention because of an Extremely Dirty System or Compressor Failure (Black Death, etc.) Filter Should be Changed for Testing. Whenever Servicing an Extremely Difficult System, Filter Change is Recommended
- ☑ Check Flow of Flush
 - ◆ Remove Hoses from Machine (Flush In/Flush Out)
 - ◆ Attach Small Piece of Hose to Flush In/Flush Out Fittings (This Loops System)
 - ◆ Turn Machine to Flush
 - ◆ If Machine Operates, Problem is Due to Severely Blocked A/C Component in Vehicle
- ☑ Never Attempt to Service Machine Internally
- ☑ Call Help Line - (845-562-1442)

COMMON QUESTIONS

QUESTION -

HOW LONG TO FLUSH?

ANSWER -

There is No Universal Amount of Time to Flush a System. You Literally Flush Until the System is Clean. This Could be Anywhere from 20 Minutes to (in the Case of a Severe Clog) Much Longer.

QUESTION -

HOW TO HANDLE SEVERELY CLOGGED A/C SYSTEM?

ANSWER -

In the Case of **BLACK DEATH**, or Other Severe Clog Problems that Stop Circulation, Allow **Cobra™ Ester Flush** to Stand in the Component and Dissolve the Clog. You Would -

- ◆ Run the **A/C Flush-It™ Hoon Yocker™** Until it Stops
- ◆ Turn Flush Valve to **OFF** Position
- ◆ Let the **Cobra™ Ester Flush** Stand for 30 Minutes (This Allows the Special Solvents to Eat Away at the Clog)
- ◆ Try Flushing Again
- ◆ Repeat as Needed
- ◆ After Successful Completion of Procedure, Change Flush Filter

NOTE: We Recommend ESTER-Based Flush Solution

Cobra™ A/C Flush Helps to Insure Against After-Service A/C System Breakdown



**NOTE: Due to the Many Variations,
Air Connectors are Not Included**



**Cobra™ Service Couplings are Supplied with the Machine,
But There May Be Other Variations for Other Applications**

For Technical Questions & Replacement Parts call 845-562-1442. In the unlikely event that you need factory repair, part or item must be securely packed and shipped prepaid to:

**Classic Tool Design, Inc.
Repair Department
31 Walnut Street, New Windsor, NY 12553**

